



Isaac B. Cox, R.L.S. (1918-1989)

Gene L. Dinkins, P.L.S., P.E.  
Gene L. Dinkins, Jr., P.L.S., LEED AP  
Sanford B. Dinkins, P.E., LEED AP  
McTilden Atkins, III, P.E.  
Laura M. Baker, P.E., LEED AP BD+C

Cox and Dinkins, Inc.  
724 Bellline Boulevard  
Columbia, South Carolina 29205

Robert T. Blackwell, P.E.  
Darren Holcombe, P.E., LEED AP  
J. Donald Rawls, Jr., P.L.S.  
David K. Ballard, P.L.S.  
Daniel C. Lam, P.E., LEED AP BD+C  
James L. Pruitt, P.E.  
Jesse T. McNeal, P.E.

(803) 254-0518, fax (803) 765-0993  
[cdinc@coxanddinkins.com](mailto:cdinc@coxanddinkins.com)  
[coxanddinkins.com](http://coxanddinkins.com)

**June 12, 2013**

## **ADDENDUM NO. 1**

### **H34-I360**

### **North Campus Blvd Repair Improvements**

#### **NOTICE TO BIDDER**

**This Addendum is issued pursuant to the Conditions of the Contract and is hereby made part of the Contract Documents. The addendum serves to clarify, revise, and supersede information in the Project Manual, the Drawings. The Bidder shall acknowledge receipt of this Addendum in the appropriate space on the Bid Form. Failure to do so may subject the Bidder to disqualification. A list of attachments, if any, is part of this document.**

**The date for receipt of bids for this project is unchanged by this Addendum.**

**QUESTIONS – a) A question was asked if the asphalt pricing would be indexed in accordance with SCDOT standards. Answer: For a project of this short duration, no indexing will be employed**

#### **ATTACHMENTS**

- a. Non-Mandatory Pre-Bid Conference Sign In Sheet
- b. Copy of email from Cannon Construction Company
- c. Sketch No. 1 for addition to Base Bid
- d. Sketch No. 2 for addition to Base Bid

**Comment from Project Engineer – The two changes depicted on Sketch No. 1 and Sketch No. 2 are reflected on the signed sealed plans provided via email. These changes are shown on Sheet C2.**

**General comments: 1. Apply first lane/traffic marking paint 24 hours after asphalt installation. Apply the final coat with glass beads 30 days later. 2. No CAD files will be available for bidding. 3. No record as-built drawings are required to be provided by the contractor. 4. There is no thermoplastic striping required on this project.**

**END OF ADDENDUM NO. 1 – Only addendum for this project**

LETT\1703 Addendum No. 1

Members

National Society of Professional Engineers • S.C. Society of Professional Engineers • S. C. Society of Registered Land Surveyors



## **Holcombe, Darren**

---

**From:** Hank Cannon <hc1@cannonbuilt.com>  
**Sent:** Monday, June 03, 2013 1:16 PM  
**To:** Holcombe, Darren  
**Subject:** Upstate North Campus Boulevard Repair/Improvements

Mr. Holcombe,

We will be bidding the above reference project. Unfortunately, we are unable to attend the pre-bid meeting. Please add us to the bid list and forward pre-bid minutes to me.

Thank you.

**Hank Cannon**  
**Cannon Construction Co., Inc.**  
**PO Box 25576**  
**Greenville, SC 29616**  
**864-286-9364 o**  
**864-286-0864 f**  
**864-616-0707 c**  
**[www.cannonbuilt.com](http://www.cannonbuilt.com)**

2" DEEP FULL  
SECTION MILL  
BASE BID

CAUTION GAS  
VALVES, SEE  
GENERAL NOTES.  
(TYPICAL)

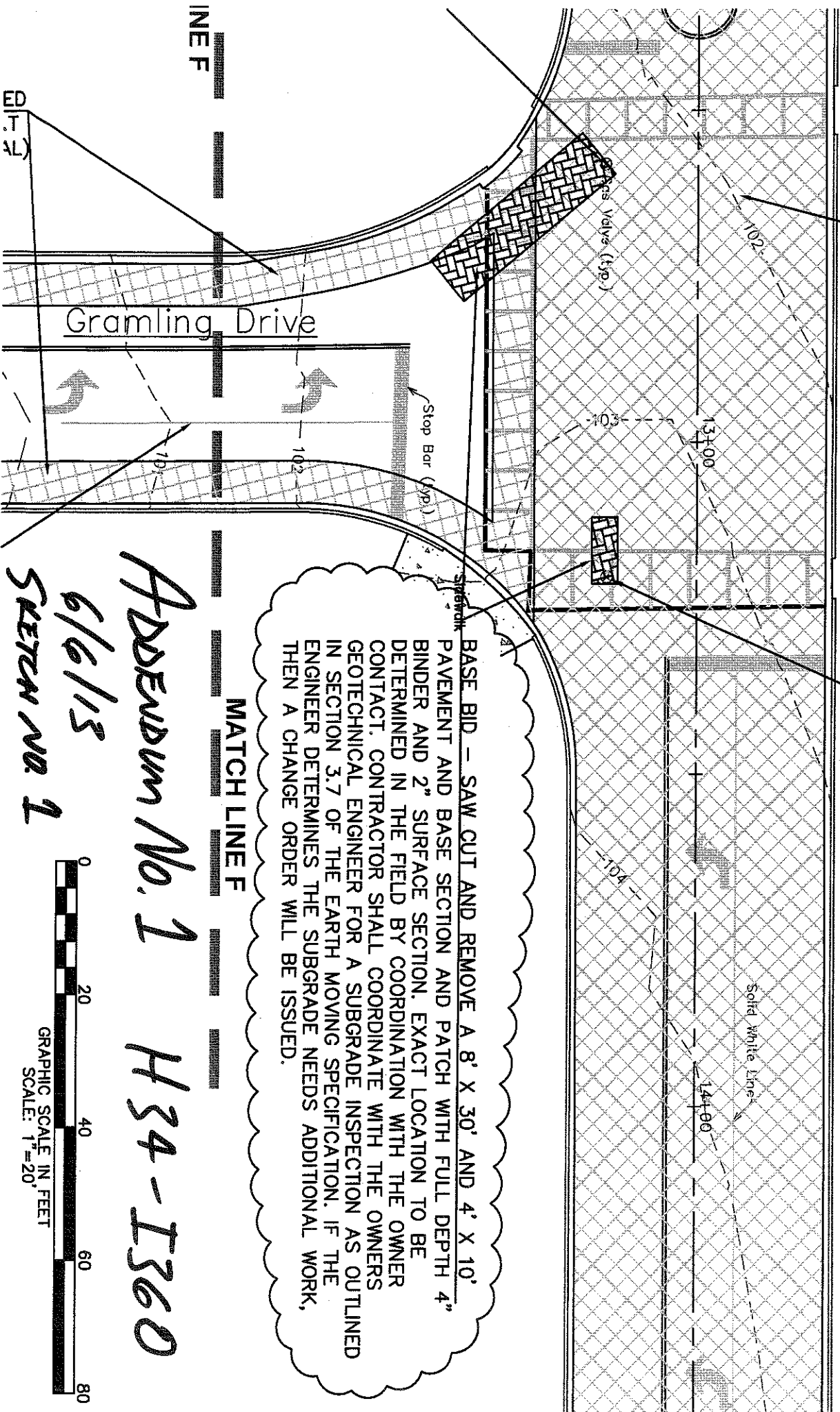

BASE BID - SAW CUT AND REMOVE A 8' X 30' AND 4' X 10' PAVEMENT AND BASE SECTION AND PATCH WITH FULL DEPTH 4" BINDER AND 2" SURFACE SECTION. EXACT LOCATION TO BE DETERMINED IN THE FIELD BY COORDINATION WITH THE OWNERS CONTACT. CONTRACTOR SHALL COORDINATE WITH THE OWNERS GEOTECHNICAL ENGINEER FOR A SUBGRADE INSPECTION AS OUTLINED IN SECTION 3.7 OF THE EARTH MOVING SPECIFICATION. IF THE ENGINEER DETERMINES THE SUBGRADE NEEDS ADDITIONAL WORK, THEN A CHANGE ORDER WILL BE ISSUED.

MATCH LINE F

ADDENDUM No. 1 H34-1360

6/6/13

SHEET NO. 1

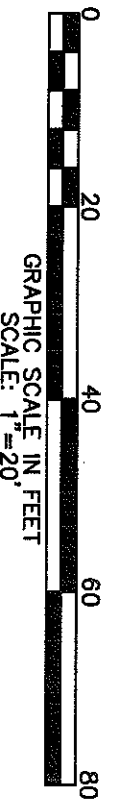

LINE F

ED

OUTSIDE ROAD EDGE TO ISLAND ISLANDS.

6" PERFORATED SLEEVES UNDER DRAINS. SEE DETAILS. ALT. NO. 1.

2 - 4" SDR 35 PVC CONDUITS FOR IRRIGATION AND ELECTRIC. ALT. NO. 1.

NEW 18" CURB AND GUTTER TO CREATE LANDSCAPE ISLAND. SEE NOTES ALT. NO. 1

2 - 4" SDR 35 PVC CONDUITS FOR IRRIGATION AND ELECTRIC. ALT. NO. 1.

NEW 18" CURB AND GUTTER TO CREATE LANDSCAPE ISLAND. SEE NOTES ALT. NO. 1

SKETCH NO. 2

ADDENDUM No. 1  
H 34-1360 6/6/13

MATCH LINE D

6" PERFORATED SLEEVES UNDER DRAINS. SEE DETAILS. ALT. NO. 1

PRELIMINARY

6-05-13

